

PIANO SILENCER
GENIO

Essence v2

User's Manual

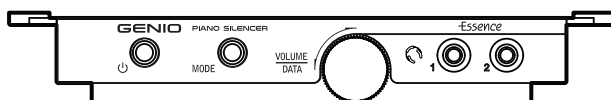

PIANO SILENCER
GENIO

Essence v2

User's Manual

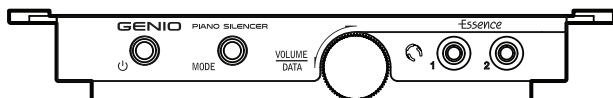

Important Safety and Installation Instructions



Information related to the possible electric shock, fire hazard and personal injury has been included in this list. Please read the contents carefully and use the product safely.

1. Be well-acquainted with this user's manual before using the product.
2. Please use the exclusive power supply. When obliged to use the other power supply, be careful of the output voltage and polarity.
3. Do not dismantle the product under any circumstances. Dismantle at discretion may not guarantee the warranty repair.
4. Keep the power cord away from the other objects. Make sure the cord is not pressed under any heavy objects or piano.
5. When using the adapter or headphones, connect or release with grasping the plug instead of cable.
6. Do not modify the power cable.
7. Do not place the power cable near heat sources, also do not heat it.
8. When removing the cable connected to the product, if you shake the cable head left and right, the terminal will become loose and cause malfunction.
9. Do not shock to the connection part while the cable is connected to the product.
10. Do not wrap the cable around the adapter.
11. Place the product away from the direct sunlight, humid, hot or cold air current.
12. The power supply cord should be unplugged from the outlet when left unused for a long time.
13. Please ask help to the dealer from whom you purchased for any after service.
14. This product is operating independently, but it can be damaged by the difference of the input/output characteristics when connected with external device.
15. Refrain from playing long time with loud sound or uncomfortable posture, it can be the reason of your hearing loss.
16. Place the product at the location or position with smooth natural air flow for proper ventilation.
17. Pay attention to any liquid like water or coffee not to be spilled. If spilled, do not disassemble the product, and ask for repair. Turning on the system under the moisture may damage the key sensors or product.
18. For the below cases, the product should be serviced by the qualified service personnel or the dealer from whom you purchased.
 - When the power supply cord or the plug has been damaged.
 - When the metal material has fallen, or liquid has been spilled on the product.
 - When the inner parts have been exposed.
 - When the product does not operate correctly.
 - When the exterior of the product has been fatally damaged.
19. Standard tuning is required for ensemble of acoustic and silent play together.
20. For correct operation, it is essential to do the initializing process after the key height adjustment or action adjustment.
21. There is a little heat generation in device during use, but it is not a problem of the product.

GENIO ESSENCE V2

With the GENIO ESSENCE V2 installed in your piano, you can keep the acoustic piano and a new concept silent piano enjoying your own playing without bothering other people, but also it becomes a digital piano with various functions available.

Regardless of time and place, enjoy your playing with providing assortment of selecting various sounds and functions for various kinds of music.

Table of Contents

Important safety and Installation Instructions	02
GENIO ESSENCE V2	03
Connection Diagram of GENIO ESSENCE V2	04
Name & Function of each part	05
How to Start GENIO ESSENCE V2	06
How to Try out Various Functions (1)	07
How to Try out Various Functions (2)	08
How to Use the Various Functions by Keys (1)	09
How to Use the Various Functions by Keys (2)	10
Initializing GENIO ESSENCE V2	12
How to Adjust the Sensitivity of individual Key Sound	13
Demo song / Connecting with External Audio Equipment	14
Connecting with the external MIDI Device	15
GM Program Chart	16
Drum Chart	17
MIDI Implementation Chart	18
Specifications	19
Trouble Shooting	20

Connection Diagram of GENIO ESSENCE V2

Upright Piano

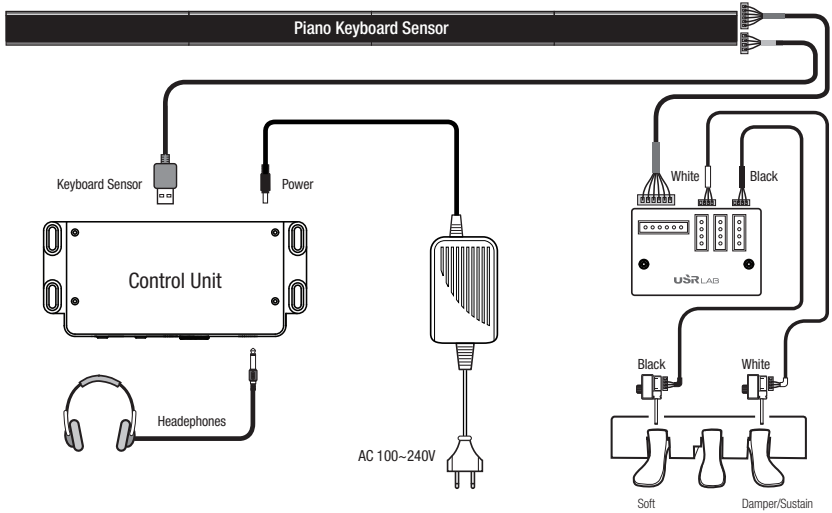

Grand Piano

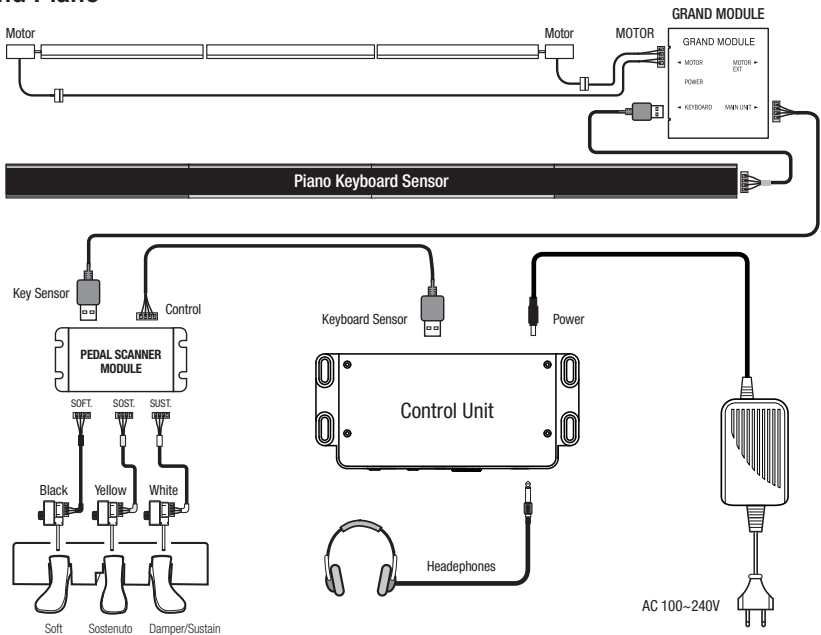

Name & Function of each part

Control Unit

Top View



Front View

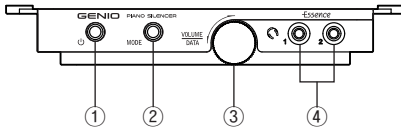

Rear View

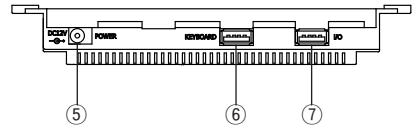

- ① **POWER BUTTON:** Turns the system on and off.
- ② **MODE BUTTON:** It's used for setting System Initializing, Reverb and Metronome.
- ③ **DIAL(BUTTON):** It's used for Volume Adjustment, Sound Selection and Adjusting Each Key's Sensitivity.
- ④ **HEADPHONES:** Monitoring the sound by connecting one or two headphones.
- ⑤ **DC JACK:** System power is provided through the power adapter.
- ⑥ **KEY BOARD:** Connects with Key Sensor Rail.
- ⑦ **MIDI:** Connects with external MIDI device through extra MIDI I/O Module. (Option)

Grand Piano Mute Controller : for Grand System

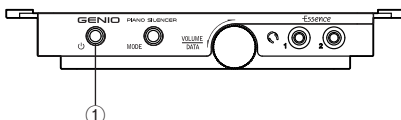

- ① **POWER BUTTON:** Press and hold the power button for more than 3 seconds to change the mute bar on/off.

How to Start GENIO ESSENCE V2

Before power on, make sure your power supply is connected correctly with 12V DC outlet.

Ready to Use

After installation, the system should be optimized to be used by the initializing process (Page 12), and it can be used with adequate connection of power supply.

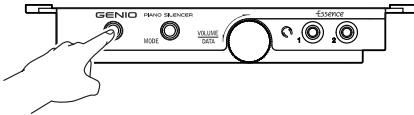

1) Power on by pressing the POWER BUTTON.

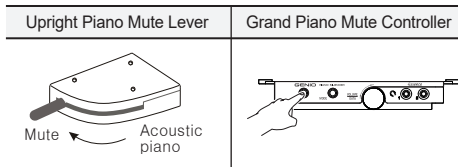

2) Mute Control

Upright Piano Mute Lever: Pull the mute lever to mute position

Grand Piano Mute Controller: Power on for mute-on, and power off for mute-off of Acoustic piano.

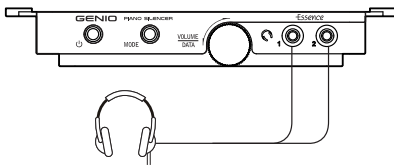

3) Plug the headphones into one of the headphone jack and wear the headphones.

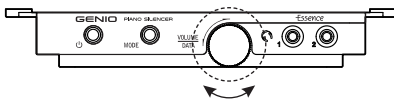

4) Select adequate volume and sound, and play the piano.

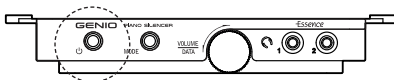

5) If you do not operate the product for 30 minutes, Genio automatically turns off.

How to Try out Various Functions (1)

Since GENIO ESSENCE V2 has various sounds and functions like digital piano, you can enjoy various music, and utilize it as a sound module with GM sounds contained.

A. Sound Selection

You can select 10 Pre-Set Sounds and 128 GM Sounds.

* Pre-set Sounds can be changed only by the manufacturer. (Users are not allowed to change it.)

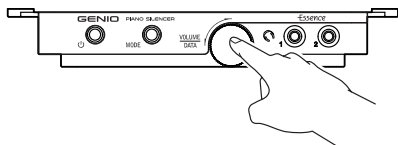

1) Press the [DIAL] BUTTON softly

* [POWER] LED flickering.

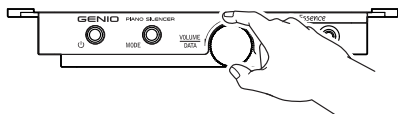

2) Turn the [DIAL] BUTTON left and right to select the sound you like.

* Press and hold the [DIAL] BUTTON for more than 2 seconds to return to default sound, Piano 1.

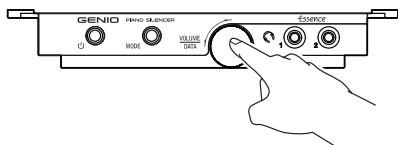

3) Press the [DIAL] BUTTON softly again to set the selected sound.

* [POWER] LED on.

Pre-Set Sounds

No.	Pre - Set
01	Piano 1
02	Piano 2
03	E. Piano 1
04	Marimba
05	Harpichord

No.	Pre - Set
06	Vibraphone
07	Strings
08	Choir Aahs
09	Percussive Organ
10	Church Organ



• **Note** : Please refer to the GM sound Chart for selecting GM Sounds.

How to Try out Various Functions (2)

B. Metronome Tempo setting by using [DIAL] BUTTON

This function can be also adjusted precisely by keys.

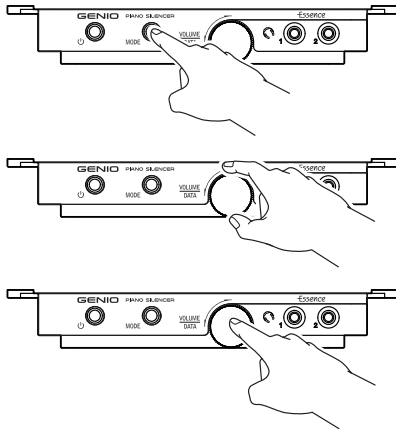

1) Press and hold [MODE] BUTTON, and release after 2 seconds.

- * [MODE] LED on.
- * Metronome turns on automatically.

2) Turn the [DIAL] BUTTON left and right to adjust the Tempo.

- * Turn right for fast tempo, Turn left for slow tempo.
- * Tempo range : 25-250
- * Press and hold the [DIAL] BUTTON for more than 2 seconds to return to default Tempo 120.

3) Press the [DIAL] BUTTON softly to set the Tempo and return to normal mode.

- * [MODE] LED out.
- * Metronome keeps working.

* It returns to default tempo 120 when re-booting the system.

C. Reverb setting

This function can be also adjusted easily by keys.

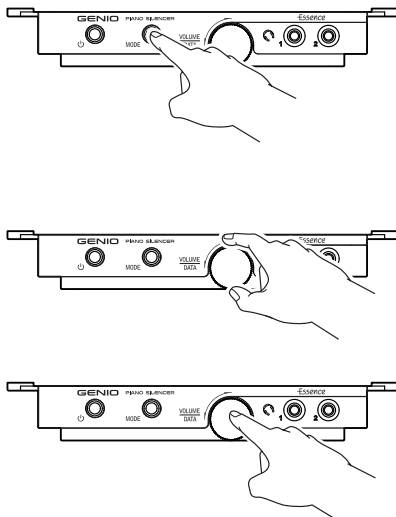

1) Press and hold [MODE] BUTTON, and release after 2 seconds.

- * [MODE] LED on.
- * Metronome turns on automatically.

2) Press [MODE] BUTTON softly again.

- * [MODE] LED flickering.
- * Metronome turns off automatically.

3) Turn the [DIAL] BUTTON left and right to adjust the reverb amount.

- * Press and hold the [DIAL] BUTTON for more than 2 seconds to return to default Reverb, 0.

4) Press the [DIAL] BUTTON softly to set the Reverb and return to normal mode.

- * [MODE] LED out.
- * Metronome turns on when it was on before.

How to Use the Various Functions by Keys (1)

Due to the limited button numbers, in order to use the various functions, press the key like below, while pressing and holding the [MODE] BUTTON, and then you can use various sounds, effects and transpose.

A. Metronome Setting

You can practice the piano with correct tempo by using the keys.

* Press the [MODE] BUTTON softly and release, and the Metronome becomes on/off.

Adjusting the Metronome Tempo by Keys

- 1) Make sure the metronome is on.
- 2) While pressing and holding the [MODE] BUTTON, enter the tempo by combining a specified number of each key.
- 3) Release the [MODE] BUTTON for completing.

* TEMPO Range : 025 ~ 250, if the compounded number is bigger than 250, 025 is automatically selected.

* If the system is powered on again, the metronome tempo comes back to default (120).

Ex) 115 Tempo Setting

While pressing and holding [MODE] BUTTON, press below keys in order.

- 1) #4 key for "1"
 - 2) #4 key for "1"
 - 3) #11 key for "5"
- and release the [MODE] BUTTON.

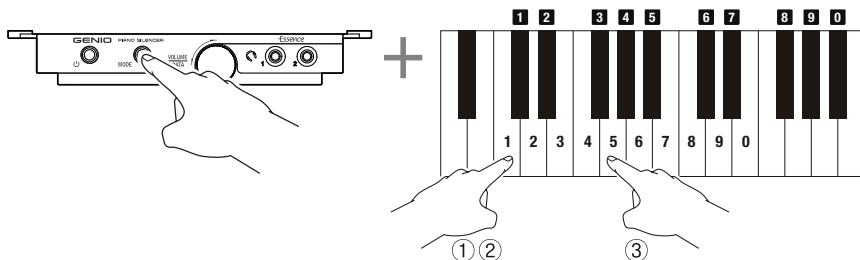

Key No.	Setting No.
#4	1
#6	2
#8	3
#9	4

Key No.	Setting No.
#11	5
#13	6
#15	7
#16	8

Key No.	Setting No.
#18	9
#20	0

How to Use the Various Functions by Keys (2)

B. How to Select 128 GM Sounds

- 1) While pressing and holding the [MODE] BUTTON, press one (or two, or three) black keys assigned with the number like the picture in below, and release the [MODE] BUTTON.

- * If the compounded number is bigger than 127, 000 : Piano 1 is automatically selected.
- * Please refer to the GM Chart (Page 16) for selecting sound number.
- * The sound exceeding from the real instrument's range of note can be different from the real sound.
- * The instrument selected by the keys is a single channel.

Ex) Selecting 106 sound

While Pressing and holding [MODE] BUTTON, press #5 for 1, #26 for 0, and #17 for 6, and release the [MODE] BUTTON for setting.

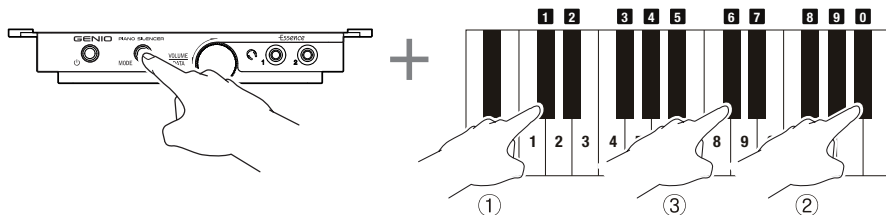

C. Velocity Curve

The touch feeling of GENIO ESSENCE V2 can be changed to accommodate the players with a lighter or heavier feeling than average touch.

- 1) While pressing and holding the [MODE] BUTTON, press one from the 5 black keys assigned with the 1~5 numbers, positioned just below the middle C.

* Default : 3

Key	Velocity Curve	Touch & Sound
29:C#3	Velocity Curve 1	Heavy
31:D#3	Velocity Curve 2	Medium Heavy
34:F#3	Velocity Curve 3	Medium (Default)
36:G#3	Velocity Curve 4	Medium Light
38:A#3	Velocity Curve 5	Light

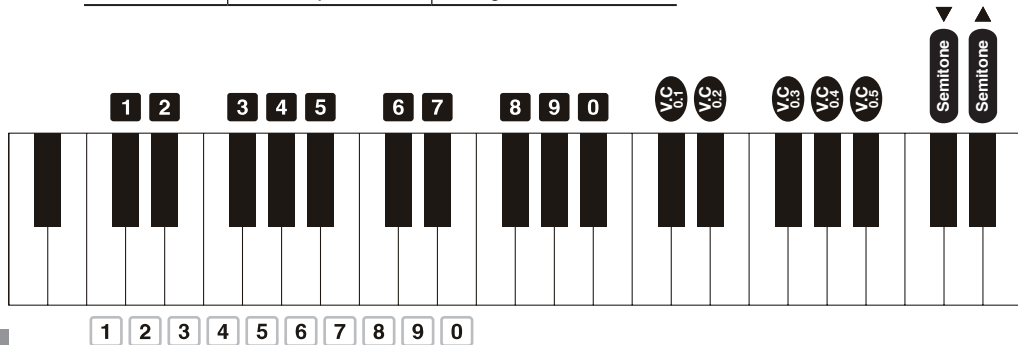

D. Transpose

- 1) While pressing and holding the [MODE] BUTTON, press the below key for semitone or octave transpose.

Key	Function	Control Range
41:C#4	Semitone Down	± 24 Semitone
43:D#4	Semitone Up	± 24 Semitone
46:F#4	Octave Down	± 24 Octave

Key	Function	Control Range
48:G#4	Octave Up	± 24 Octave
50:A#4	Reset	0

E. Reverb, Chorus (Effects)

- 1) While pressing and holding the [MODE] BUTTON, press the below keys for selecting desired chorus and reverb type, and adjusting the depth of both types.

Key	Function	Control Range
53:C#5	Reverb Down	000
55:D#5	Reverb Up	127
58:F#5	Chorus Down	000

Key	Function	Control Range
60:G#5	Chorus Up	127
65:C#6	Reverb Type	4 Types
67:D#6	Chorus Type	3 Types

F. Bright Sound

- 1) While pressing and holding the [MODE.] button, press below keys for Bright Sound ON/OFF

Key	Function	Control Range
83:G7	Bright Sound OFF	0

Key	Function	Control Range
85:A7	Bright Sound ON	0

G. Instrument setting / Save and Reset

You can select the instrument and effect sound, the data can save or reset.

- 1) While pressing and holding the [MODE] BUTTON, press one key assigned with the number like the chart in below.

Key	Function
82	RESET

Key	Function
84	SAVE

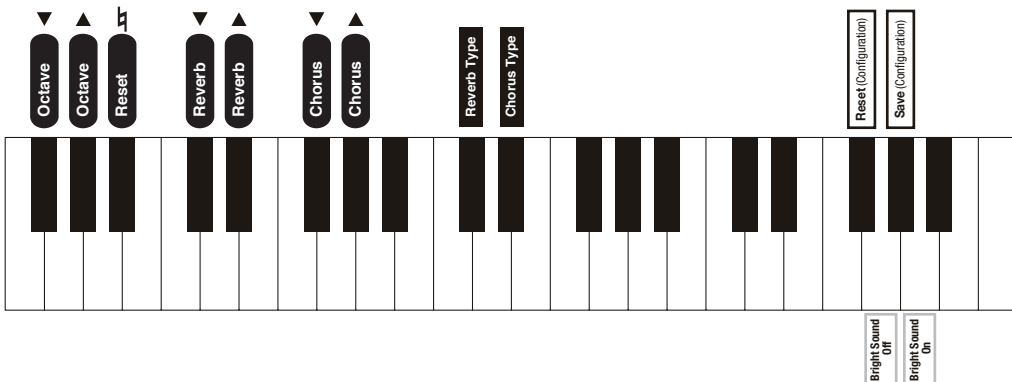

Initializing GENIO ESSENCE V2

GENIO ESSENCE V2 enables you to hear your own sound during the piano muting. The signals generated by actinography from the sensors underneath the keys convert into MIDI signals which are needed for generating the piano sound by control unit's program.

Since GENIO ESSENCE V2 adopts continuous position detective photo sensors, after installation, by initializing process, it records the characteristics of keys and sensors into the memory storage to generate the sounds. Without correct initializing process, some keys have no sound, or generate irregular sound, so it is essential to initialize perfectly to keep the best performance.

A. Before Initializing

- 1) Every connection of cables should be perfect.
- 2) The mute lever should be in mute position.
- 3) Make sure that nothing is sitting on the keys that might press keys down.
- 4) Mechanical regulation of the piano action like let-off should be perfect to prevent malfunction.

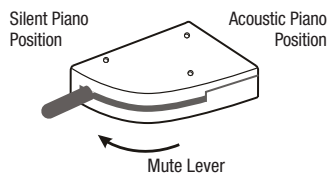

B. How to Initialize GENIO ESSENCE V2

- 1) While pressing and holding the [MODE] BUTTON, press [POWER] BUTTON to turn on GENIO ESSENCE V2.

(([POWER] LED flickers for 3-5 seconds, and on.)



- 2) Press each of 88 keys and pedals one by one, all with slowly and softly.
 - * Don't press next key before the prior key is not released.
 - * Once a key is initialized, you can hear the corresponding key sound.
 - * Once you softly press the initialized key again, you can hear the key sound.
- 3) After the above process, please press all keys and pedals AGAIN to check if you can hear each note's sound well or not.
 - * If a certain key is not initialized (if you cannot hear the sound), press and hold that key for more than 2 seconds again, that key would be re-initialized. (It remembers the last key position.)
 - * If the key is not re-initialized after pressed again, turn off the system and try from the first step.
- 4) After completion of the initializing all keys and pedals, press [MODE] BUTTON again.
 - * Just [POWER] LED on.



- **Note:** After installation or if the piano is not used for a long time or recently moved, GENIO ESSENCE V2 should be initialized properly since the depth of the keys can be changed. Please let the skilled expert help you how to initialize.

How to Adjust the Sensitivity of Individual Key Sound

The initializing procedure on the previous page should make all of the keys equally sensitive. If you find some keys still play too loudly or softly, use the following procedure to adjust the sensitivity of individual key.

- 1) Press and hold the [DIAL] BUTTON, and turn on the system with [POWER] BUTTON.

* [POWER] LED flickering for 3-5 seconds, and then flickering long and shortly. (Pattern : - · · - ·)



- 2) Wear the headphones to monitor the sound, and find which key has to be adjusted.

- 3) If the sensitivity needs to be adjusted in a key, turn the [DIAL] BUTTON right or left to find the adequate sound volume.

* Turning left makes it insensitive, and turning right makes it sensitive.

* In order to return to the previous value, press and hold the [DIAL] BUTTON for around 2 seconds.

* When the adjustment is working, [MODE] BUTTON LED is flickering.

- How to recover to original sensitivity for a specific key during the process of individual key sensitivity adjustment.

① Press the key which is one step lower than the pertinent key, and press [MODE] BUTTON softly.

② After [MODE] BUTTON becomes flickering, press the pertinent key once and press [MODE] BUTTON softly.

③ And then, the sensitivity of the specific key recovers into initial setting.

- 4) After completing the key adjustment, press [DIAL] BUTTON softly.

* [MODE] LED would be flickering, and then [POWER] LED becomes on for returning normal mode.

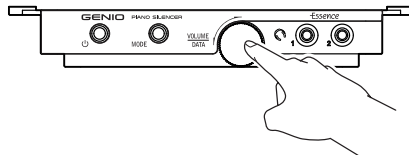

Demo song / Connecting with External Audio Equipment

Your GENIO ESSENCE V2 has built-in one piano demo song for your product quality checking, enjoy and education.

- 1) Press both [MODE] + [DIAL] BUTTON together for more than 2 seconds to get into demo mode.
(Press and hold the button until power LED flickering)

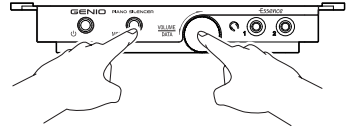

- 2) Press the [DIAL] BUTTON for more than 2 seconds.
(* [POWER] LED and [MODE] LED on.)

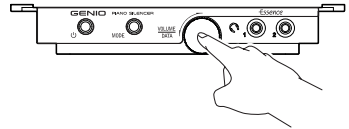

- 3) Press the [DIAL] BUTTON softly and return to normal mode.

Amplified piano playing through External Audio Equipment

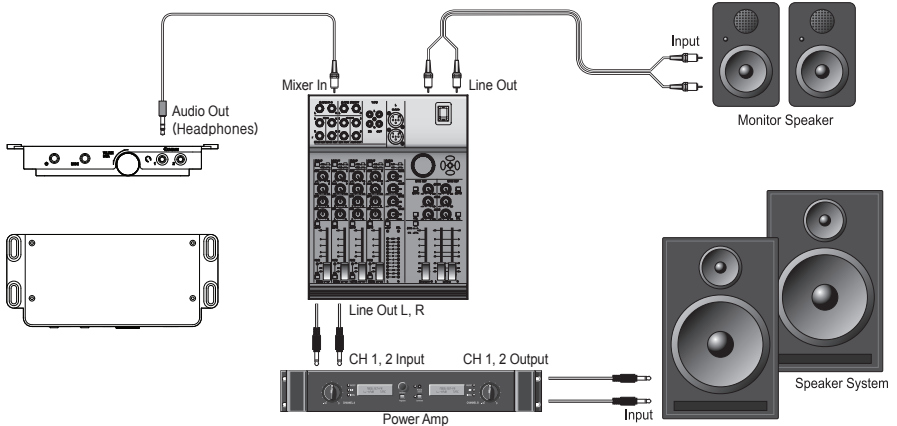

- A. Connect the audio cable from the headphones socket to the AUX IN of the audio equipment. And adjust the audio volume.
- B. The volume of the signals coming out from the headphones socket can be also adjusted in external audio, and it should be adequately adjusted in order not to exceed the capacity of the audio device.

Connecting with the External MIDI Device

Please refer to the MIDI Implementation Chart for the Control Command of connection parameters with external MIDI devices.

A. Data transmission to external MIDI device

By playing GENIO ESSENCE V2, You can regenerate the sound from the other MIDI device, and you can edit the sound by using MIDI program of the computer.

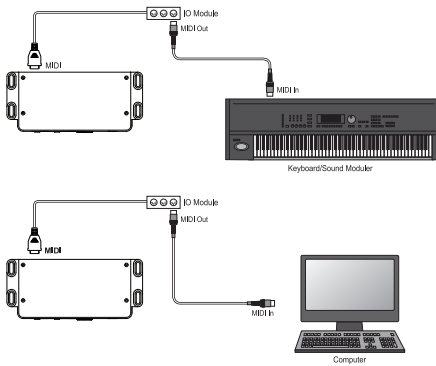

- A. Connect MIDI Cable (5 Pin Round Din Cable) from the ESSENCE MIDI Output socket to the MIDI Input socket of external device.
- B. Use the Input setting of external MIDI device.
- C. MIDI I/O module : option

B. Data reception from external MIDI device

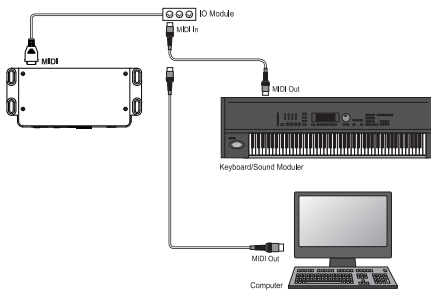

- A. Connect the MIDI cable from the external MIDI device Output socket to ESSENCE V2 Input socket.
- B. ESSENCE V2 provides the sound source only, so control the parameters from the external MIDI device.
- C. GM, Patch or some sound volume/color may differ from the each manufacturer, so the songs worked with the other sound sources may have the different feeling.

GM Program Chart

Piano

000	Piano 1	004	E.Piano 1
001	Piano 2	005	E.Piano 2
002	Piano 3	006	Harpsichord
003	Piano 4	007	Clavinet

Organ

016	Organ 1	020	Reed Organ
017	Organ 2	021	Accordion
018	Organ 3	022	Harmonica
019	Church Organ	023	Bandneon

Bass

032	Acoustic Bs.2	036	Slap Bass 1
033	Fingered Bs	037	Slap Bass
034	Picked Bass	038	Synth Bass 1
035	Fretless Bs	039	Synth Bass 2

Ensemble

048	Strings 0	052	Chair Aahs
049	Slow Strings	053	Voice Oohs
050	Syn. Str 1	054	Synth Vox
051	Syn. Str 2	055	Ochestra Hit

Reed

064	Soprano Sax	068	Oboe
065	Alto Sax	069	English Horn
066	Tenor Sax	070	Bassoon
067	Baritone Sax	071	Clarinet

Synth Lead

080	Square Wave	084	Charang
081	Saw Wave	085	Solo Box
082	Syn.Calliope	086	5th Saw Wave
083	Chiffer Lead	087	Bass & Lead

Synth SFX

096	Ice Rain	100	Brightness
097	Sound track	101	Goblin
098	Crystal	102	Echo Drops
099	Atmosphere	103	Synth Bass 2

Percussive

112	Tinkel Bell	116	Taiko
113	Agogo	117	Melo Tom
114	Steel Drums	118	Synth Drums
115	Woodblock	119	Reverse Cym

Chromatic Percussion

008	Celesta	012	Marimba
009	Glockenspiel	013	Xylophone
010	Music Box	014	Tubular-bells
011	Vibraphon	015	Dulcimer

Guitar

024	Nylon-str.Gt	028	Muted Guitar
025	Steel-str.Gt	029	Overdrive Gt
026	Jazz Guitar	030	Distortion Gt
027	Clean Guitar	031	Gt.Harmonics

String / Orchestra

040	Violin	044	Tremolo Str
041	Viola	045	Pizzicato St
042	Cello	046	Harp
043	Contrabass	047	Timpani

Brass

056	Trumpet 1	060	French Horn
057	Trombone	061	Brass
058	Tuba	062	Synth Brass 1
059	Muted Trumpet	063	Synth Brass 2

Pipe

072	Piccolo	076	Bottle Blow
073	Flute	077	Shakuhachi
074	Recorder	078	Whistle
075	Pan Flute	079	Ocarina

Synth Pad etc.

088	Fantasia	092	Bowed Glass
089	Warm Pad	093	Metal Pad
090	Polysynth	094	Halo Pad
091	Space Voice	095	Sweet Pad

Ethnic

104	Sitar	108	Kalima
105	Banjo	109	Bag Pipe
106	Shamisen	110	Fiddle
107	Koto	111	Shannai

SFX

120	Gt.FretNoise	124	Telephone
121	Breath Noise	125	Helicopter
122	Seashore	126	Applause
123	Bird	127	Gun Shot

Drum Chart

No.	Standard Set
27 D#1	High Q
28 E1	Slap
29 F1	Stratch Push
30 F#1	Stratch Pull
31 G1	Sticks
32 G#1	Square Click
33 A1	Metronome Click
34 A#1	Metronome Bell
35 B1	Bass Drum 2 (Acoust)
36 C2	Bass Drum 1 (Rock)
37 C#2	Side Stick
38 D2	Snare Drum 1
39 D#2	Hard Clap
40 E2	Snare Drum 2
41 F2	Low Floor Tom
42 F#2	Closed HiHat (EXC1)
43 G2	High Floor Tom
44 G#2	Peadal HiHat (EXC1)
45 A2	Low Tom
46 A#2	Open HiHat (EXC1)
47 B2	LowMid Tom
48 C3	Hi Mid Tom
49 C#3	Crash Cymbal 1
50 D3	High Tom
51 D#3	Ride Cymbal 1
52 E3	Chines Cymbal
53 F3	Ride Bell
54 F#3	Tambourine
55 G3	Splash Cymbal
56 G#3	Cowbell
57 A3	Crash Cymbal 2

No.	Standard Set
58 A#3	Vibraslap
59 B3	Ride Cymbal 2
60 C4	Hi Bongo
61 C#4	Lo Bongo
62 D4	Mute Hi Conga
63 D#4	Open Hi Conga
64 E4	Low Conga
65 F4	High Timnale
66 F#4	Low Timbal
67 G4	High Agogo
68 G#4	Low Agogo
69 A4	Cabasa
70 A#4	Maracas
71 B4	Short Whistle (EXC2)
72 C5	Long Whistle (EXC2)
73 C#5	Short Guire (EXC3)
74 D5	Long Guiree (EXC3)
75 D#5	Claves
76 E5	Hi Wood Block
77 F5	Low Wood Block
78 F#5	Mute Cuica (EXC4)
79 G5	Open Cuica (EXC4)
80 G#5	Mute Triangle (EXC5)
81 A5	Open Triangle (EXC5)
82 A#5	Shaker
83 B5	Jingle Bell
84 C6	Belltree
85 C#6	Castanets
86 D6	Mute Surdo (EXC6)
87 D#6	Open Surdo (EXC6)
88 E6	

MIDI Implementation Chart

Function		Transmitted	Received	Remark
MIDI Channels		1~16	1~16	
Mode		X	3	
Note Number		21~108	0 ~127	
Velocity				
Note On		9n, V = 127	9n, V = 127	
Note Off		9n, V = 0	8n, V = 0 ~127	
Key Aftertouch		X	X	
Channer Aftertouch		X	0	
Pitch Bend		X	0	+ -2 Octave Pitch Band Sensitivity recognized
Control Change	0, 32	X	0	Bank Seselect
	1	X	0	Modulation
	6, 38	X	0	Data Entry
	7	X	0	Main Volume
	10	X	0	Pan
	11	X	0	Expression
	64	0	0	Damper Pedal
	67	0	0	Soft Pedal
	91	X	0	Reverb Depth
	93	X	0	Chorus Depth
	98	X	0	NRPN LSB
	99	X	0	NRPN MSB
	100	X	0	RPN LAB
	101	X	0	RPN MSB
	120	X	0	All Sound Off
121	X	0	Reset All Controllers	
123	X	0	All Note Off	
Programme Change		X	0 (0 ~127)	

Note :

- 1) Default Pitch Bend = 1 Semitone
- 2) Mode 1 : OMNI On, Poly
- 3) Mode 2 : OMNI Off, Poly

Specifications

Item		Description	
Silent Mechanism		Universal Mute Rail by Manual Lever	
Sensor Keyboard		Reflector Type Touchless Optic Sensor System	
Velocity		127 Level	
Touch Response		5 Curves	
Sensitivity of each keys		Individual Adjustment Range from 000 to 255	
Sensor Pedal		Sustain, Soft	
Sounds		10 Pre-Set, 128 GM Sounds	
Sounds Memory		512 MB	
Polyphony		256 Poly	
Transpose		± 24 Semitone	
Effect	Reverb	Type	4
		Range	000 ~ 127
	Chorus	Type	3
		Range	000 ~ 127
Pitch	Standard	444 Hz	
Metronome	Tempo	25 ~ 250	
Display		2 LEDs	
Headphone Jack		1/8" x 2 Jaks	
MIDI Port		Input / Out / Thru (Extra MIDI I/O Module)	
Audio (Headphones)		Out (Stereo)	
Power Supply		Input : AC 100 ~ 240V, Output: DC 12V, 1.5A	
Dimension of Control Unit		171 x 19 x 76mm (W x H x D)	
Remark			

* **For Grand Piano** : universal Mute Rail by Auto Lever, controlled by the Grand Piano Mute Controller Sustain, Sostenuto, Soft Pedal Sensors

* Above specifications are subject to change without notice.

Trouble Shooting

Phenomenon	Possible cause and Trouble shooting
No Power	<ul style="list-style-type: none">• Check if AC plug is connected correctly with the outlet.• Check if DC jack is connected correctly with the control unit.
No Sound	<ul style="list-style-type: none">• If metronome works well with the sound, check the connection of key sensors and control unit.• If metronome doesn't work, check the headphones connection or volume control.• If the key have no sound, initialize (page 12) the system again.• Check if there's any foreign substance on the key sensors.
Noisy Sound	<ul style="list-style-type: none">• If there's no noisy sound when the volume is down, it's the headphones problem.

- **Note** : If you use the other headphones which is not supplied with a basic kit item, the sound maybe different from each headphones' manufacturer.



USRLab

610 J-Tower, 330 Yeomjeon-ro, Michuhol-gu, Incheon, 22126 Korea
TEL: +82 (0)32-505-6541 FAX: +82 (0)32-724-0542

www.usrlab.kr